

INSTALLATION MANUAL

CALISTA 917



CALISTA 917 – V04_202112_EN

JC BORDELET
c r é a t e u r d ' h a r m o n i e

TECHNICAL INFORMATION

It is necessary to comply with all national regulations, especially those referring to national and European standards, when installing the appliance.

JC BORDELET recommends installing the appliance at a minimum distance of 100 mm from non-combustible walls to ensure good efficiency of the appliance and facilitate assembly.

Since this appliance is airtight, connection to outside air can be made either through a triple wall flue duct or by direct connection through a connection kit.

For any direct connection to the outside air, it is mandatory to ensure that the inlet sections are sufficient according to their length and re-routing.

In case of installation of a triple wall flue duct connection, the installation instructions and precautions found in the Technical Application Document of said duct should be complied with, in addition to these instructions. Minimum flue height needed for proper appliance operation is 4.5m.

This appliance must not be installed on a smoke duct or an air supply serving another appliance.

Exhaust fans in the same room or space as this appliance may cause operating problems. (backdraft of smoke, variable combustion rate). The compatibility of the appliance with any exhaust fan should be ensured.

Exhaust fans have no impact on combustion if the combustion air inflow is ducted, the air is drawn from outside the building, the door(s) are properly locked, and all the air seals are not deteriorated.

The appliance must be suspended according to the recommendations of JC BORDELET based on the information given and validated by the installer.

It is necessary to provide an access for cleaning the appliance, the connection duct and the smoke duct.

Place any air intake grille in such a way that it cannot be obstructed.

A minimum distance of 1000 mm between the unit and any combustible material should be maintained when the latter is pivoting. For all other configurations, refer to the following page

For reasons of space, all our appliances are delivered in separate components. The assembly must be carried out in accordance with this installation manual and according to the drawing provided by JC BORDELET after study of the installation.

During installation, it is advisable to leave the protection devices present on the appliance and to remove them only after all the assembly operations are completed.

The actual definitions of certain parts described in this manual may change without affecting the installation and/or operation.

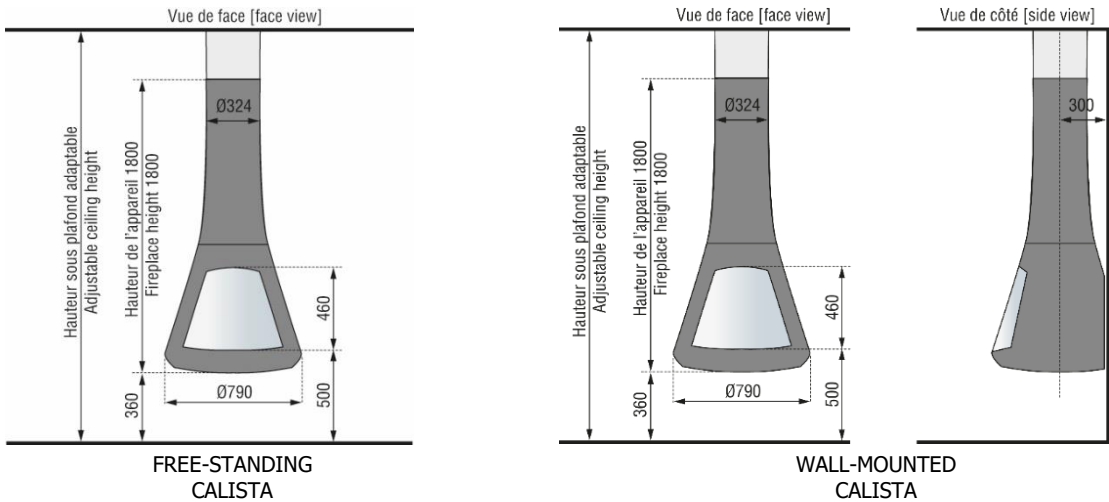

Type	MT180917FF
Indirect heating	NO
Rated thermal power	9,3 kW
Useful thermal power emitted in the room	9,3 kW
Rendement énergétique (hnom)	75 %
CO (13% O2) (CO _{nom})	0,09 %
CO (13% O2) (CO _{nom})	1063 mg/Nm3
PM (13% O2) (PM _{nom})	35 mg/Nm3
COG (13% O2) (COV _{nom})	116 mg/Nm3
NOx (13% O2) (NOx _{nom})	112 mg/Nm3
CO2	9,2%
Smoke temperature	326°C
Smoke temperature at the nozzle outlet (T _{nom})	391°C
Minimum draft - Nominal draft (p _{nom})	12 Pa
Maximum draft	20 Pa
Fuel	Logs of dry wood 25cm
Recommended wood load	2 logs of 1kg 25 cm lenght split in ¼
Type of combustion	Intermittent combustion
Refuelling intervals	45min
Mass flow rate of smoke	9 g/s
Smoke discharge diameter	Ø150 mm
Air inlet diameter	Ø80 mm
Mini combustion air inlet section (useful)	100 cm²
Airtight according to EN 16510-1	OUI
If tight, leakage under 10Pa according to EN 16510-1	3m3/h
Mass of appliance only	180 kg
Mass per meter of additional extension	40 kg
Seasonal space heating energy efficiency	65 %
Energy efficiency index	98
Energy efficiency class	A
Minimum distance between the glass pane of the appliance and all combustible materials	1000mm
Minimum distance between the side of the appliance and any combustible materials (dS)	250mm
Minimum distance between the rear of the appliance and any combustible materials (dR)	250mm
Minimum distance between the bottom of the appliance and any combustible materials (dF)	340mm

In case of a wall-mounted appliance, the backing wall must be made of non-combustible material

* The backing wall must be made of non-combustible material and the whole surface of the construction right-of-way must be insulated.

The insulation must be in the M0, A2s1d0 or A1 reaction-to-fire class and must have a thermal resistance higher than 0.7m².K/W (measured at 50°C).

The insulation must not deteriorate at temperatures below 400°C (e.g. calcium silicate, rock mineral wool, etc.).

If the backing wall is made of combustible material, it is necessary either:

- to remove the combustible material and to install insulation as described above;
- or to place a non-combustible partition at a distance of least 2cm from the combustible material wall and to ventilate by two openings (bottom and top).

An insulation layer must then be placed on the partition as described above.

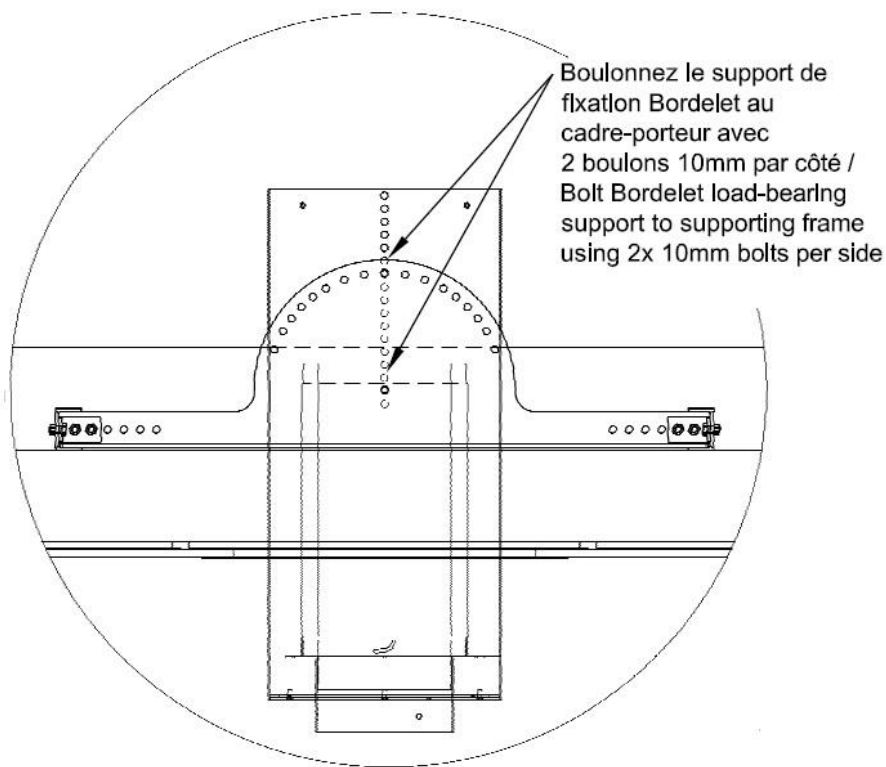
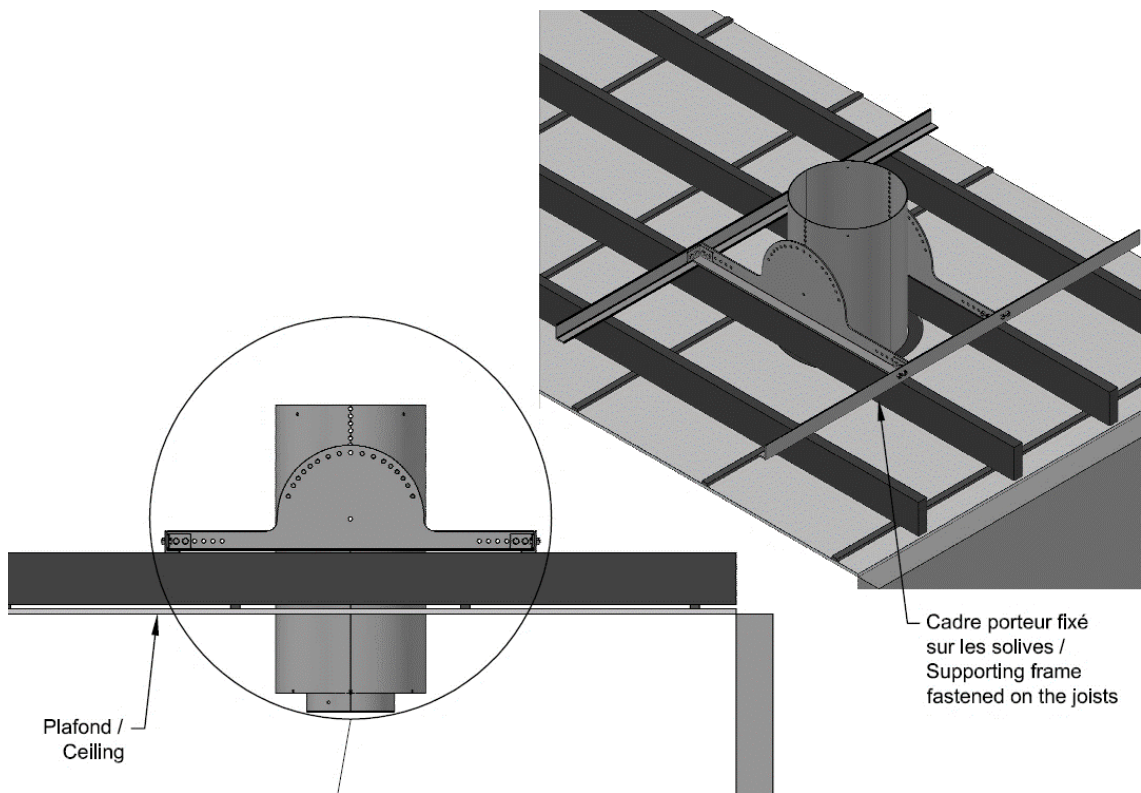

1-FASTENING HARDWARE INSTALLATION / SLOPING ROOF

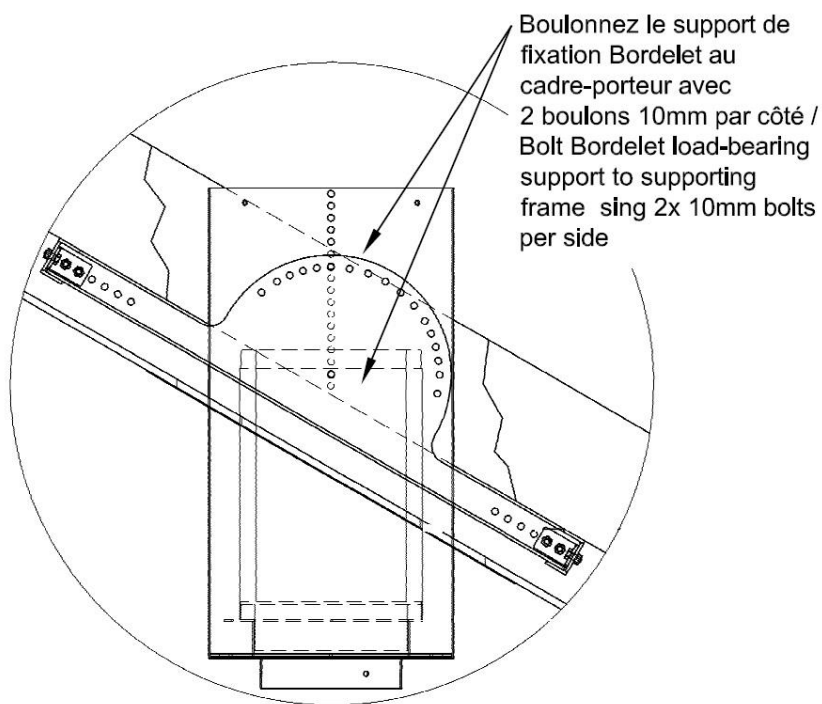
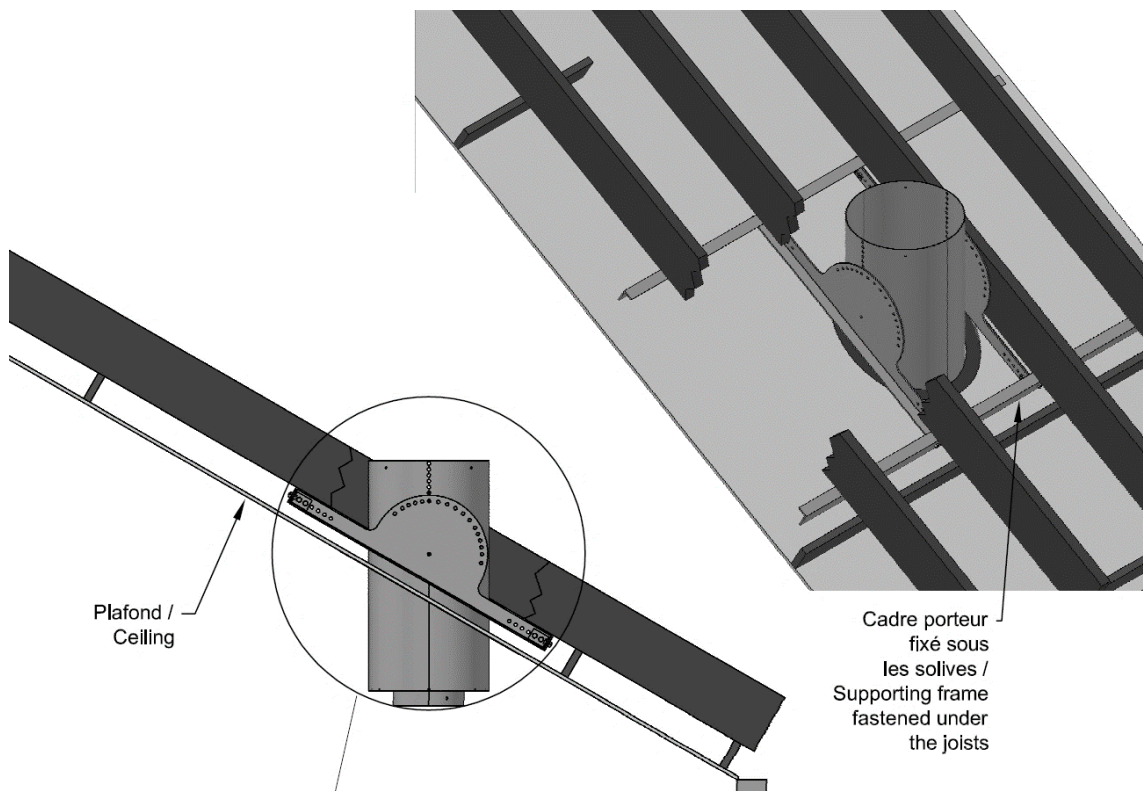

2-CONNECTION TO COMBUSTION AIR (WALL-MOUNTED)

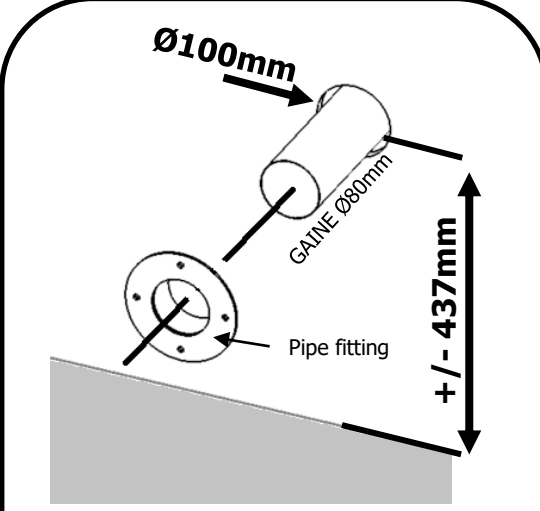

Ø100mm

GAIN Ø80mm

Pipe fitting

+/- 437mm

Drill the wall in the flue axis
Insert the sheath Ø80 in the hole in the wall
Fix the pipe fitting to the sheath using a clamp

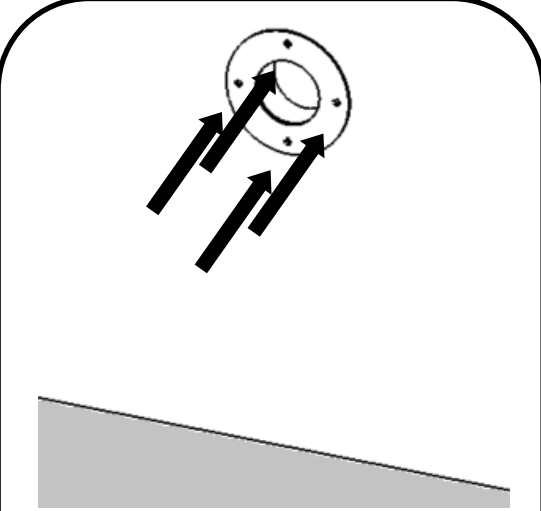

Fix the pipe fitting to the wall using 4 screws suitable to the wall type (countersunk screws)

DIRECT CONNECTION (WITHOUT TRIPLE WALL FLUE DUCT)

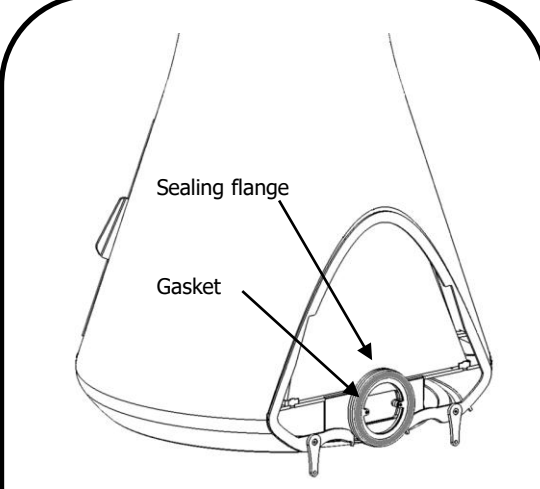

Sealing flange

Gasket

Check the presence of the gasket and the sealing flange behind CALISTA

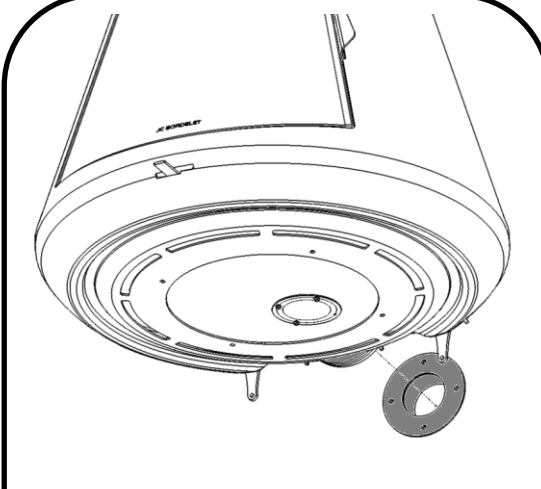

In stage 8, make sure that the sealing flange and the pipe fitting fixed to the wall are opposite and that the gasket is compressed



Remove the sealing flange behind CALISTA

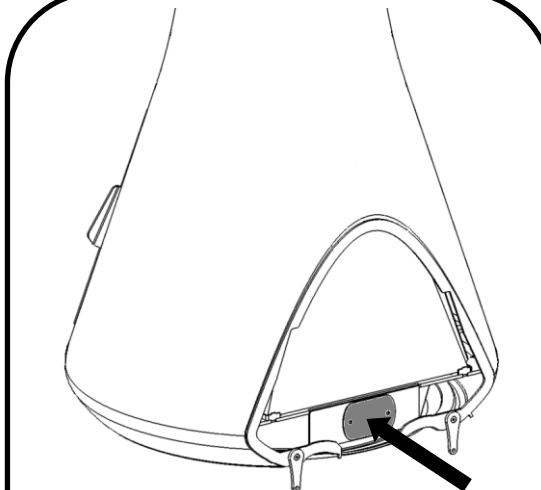

Install the plug in the place of the sealing flange

CONNECTION WITH TRIPLE WALL FLUE DUCT

3-INSTALLATION OF THE CEILING COVER PLATE

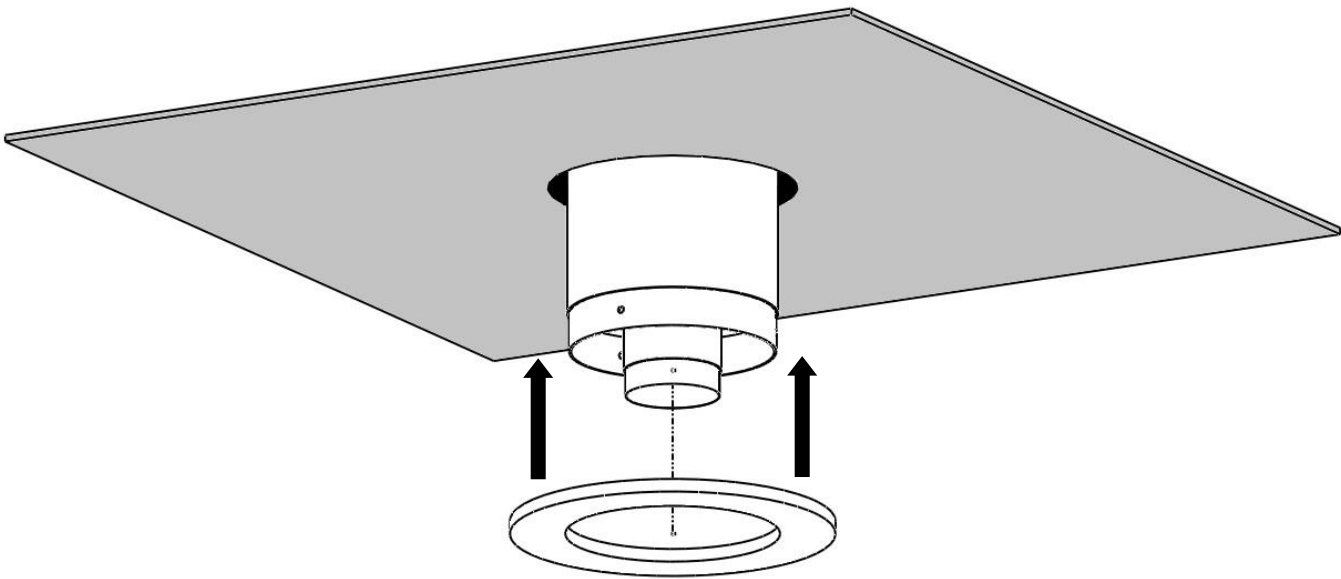

4-INSTALLATION OF FLUE DUCTS

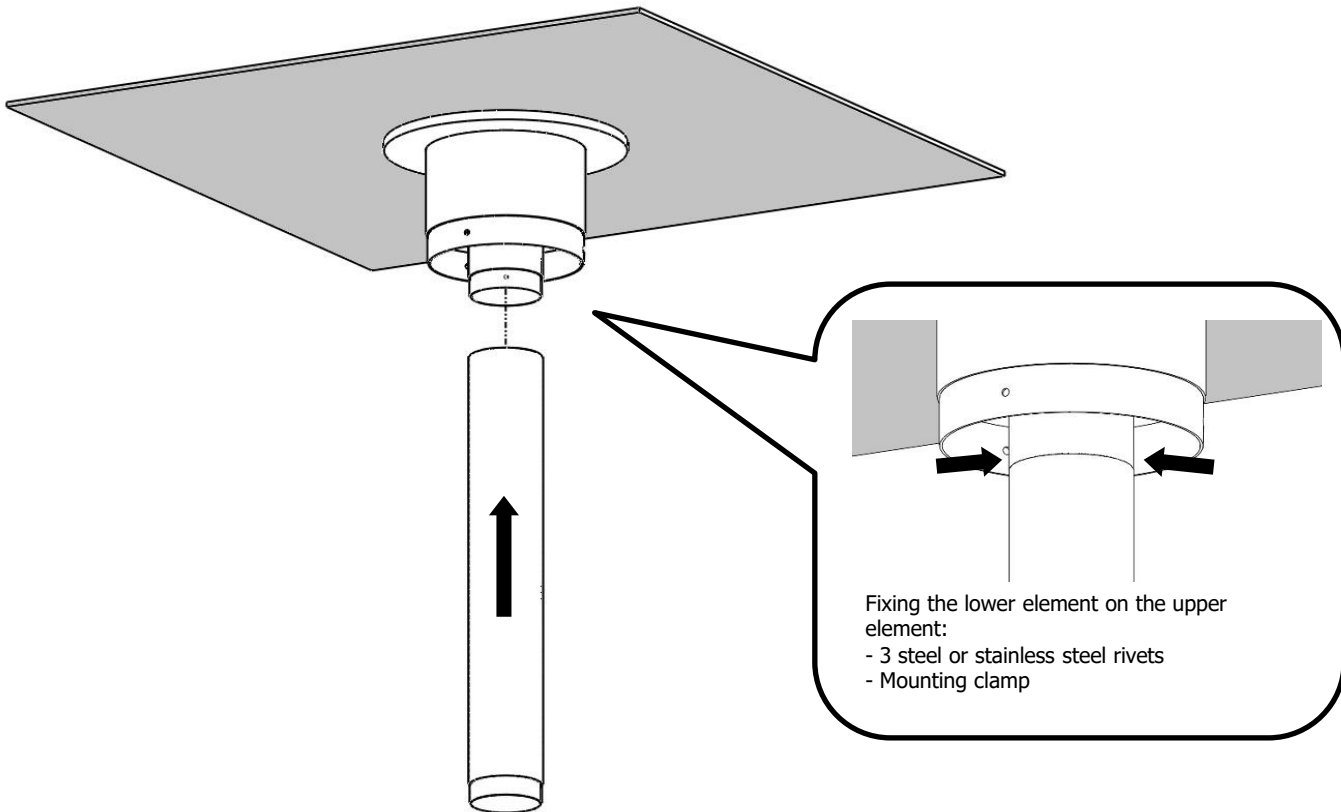

5-INSTALLATION OF EXTENSIONS

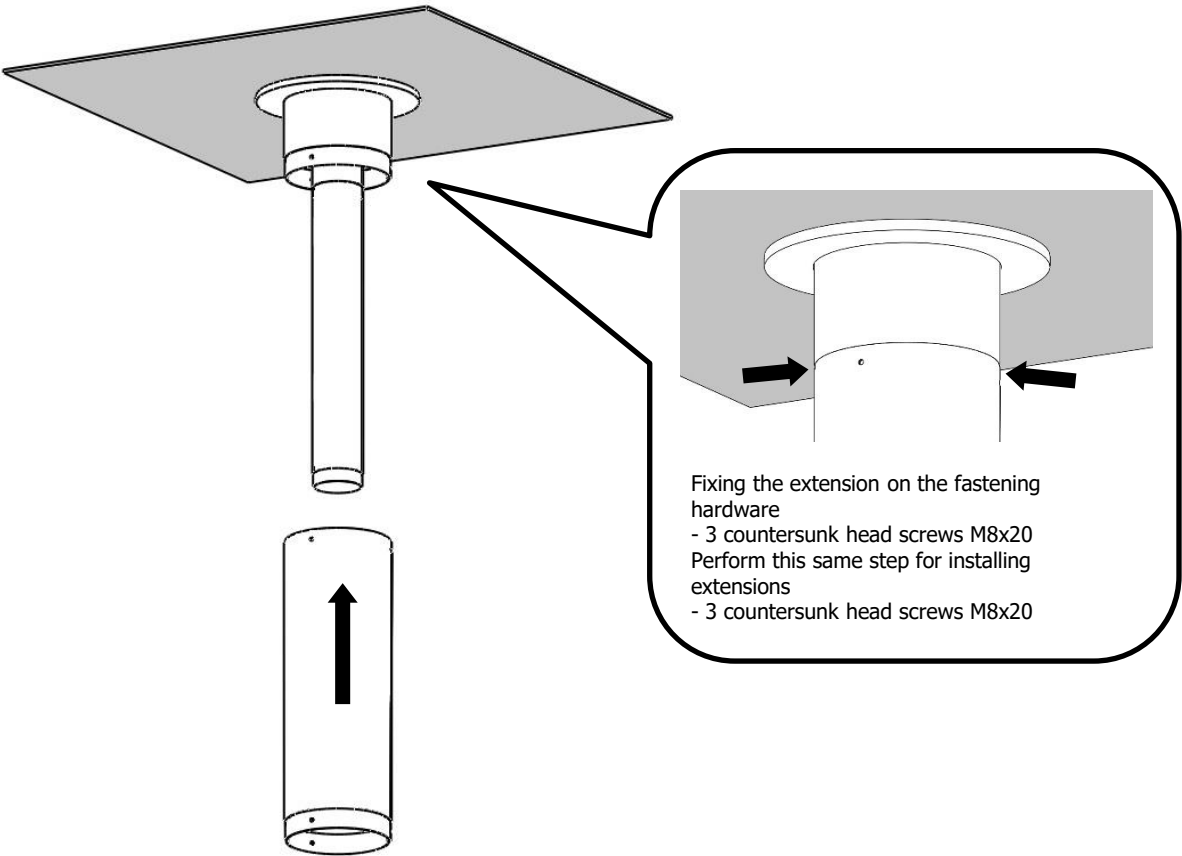

6-INSTALLATION OF THE ANTI-SWAY SYSTEM (FREE-STANDING)

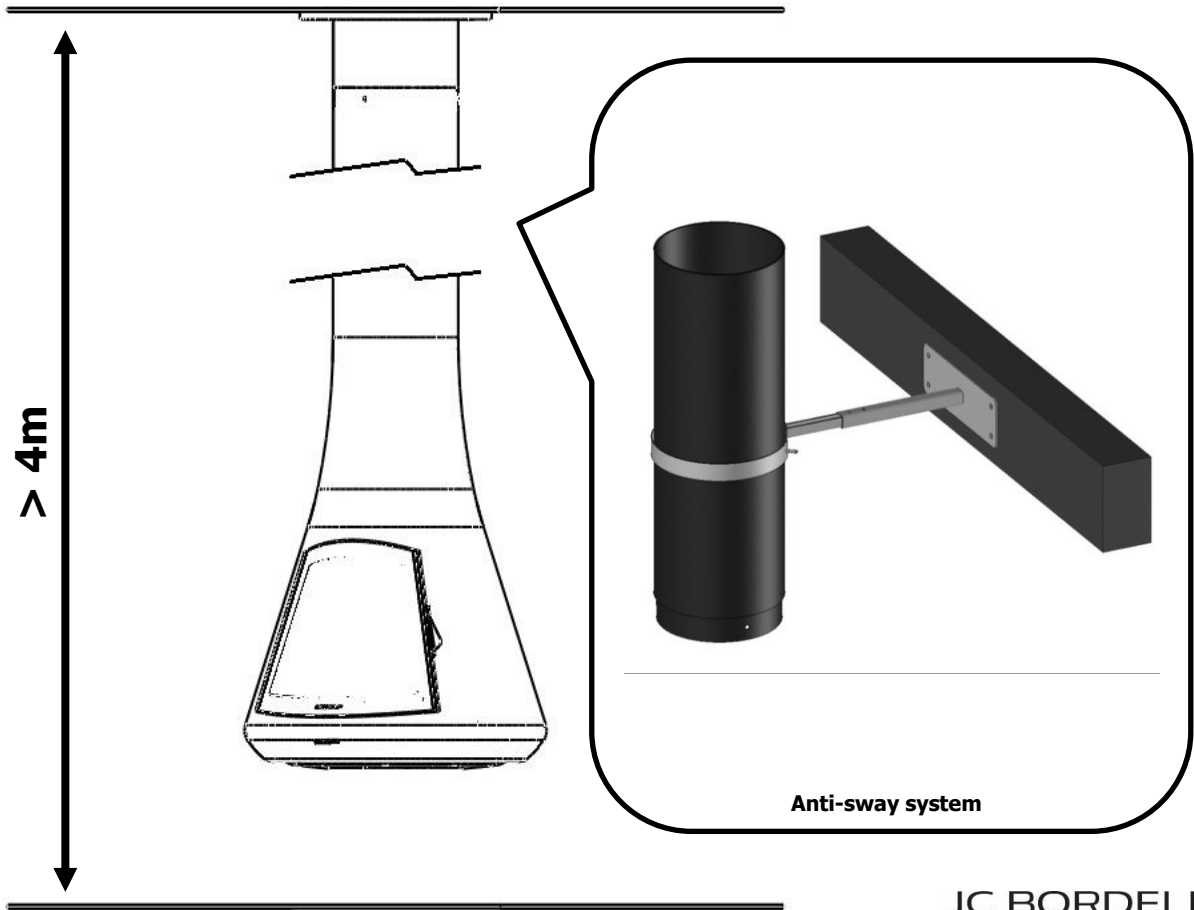

7.1

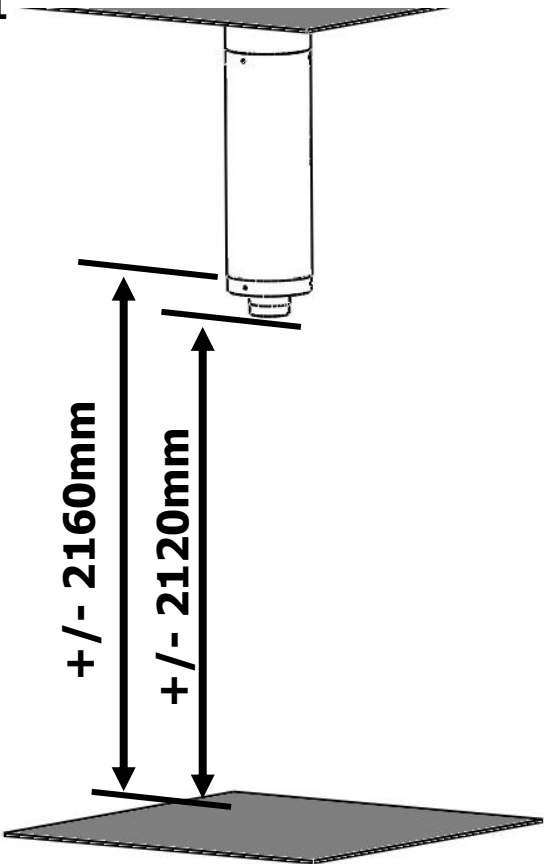

7.2

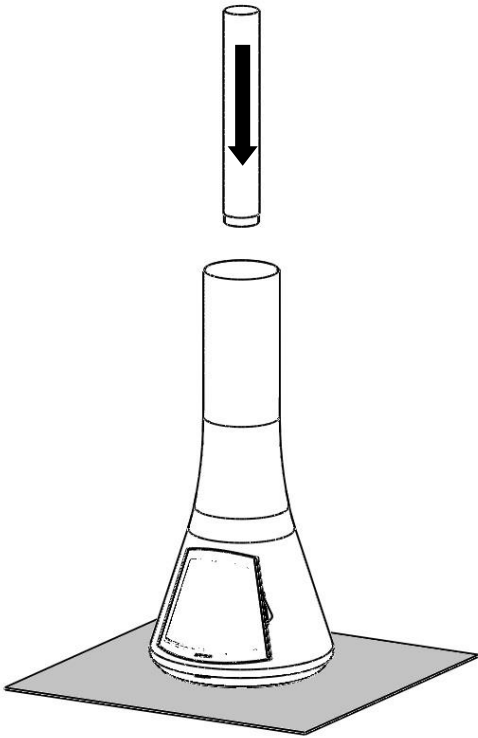

Assembly of the connection element in the appliance excluding the ducts and extensions installed in the previous steps

7.3

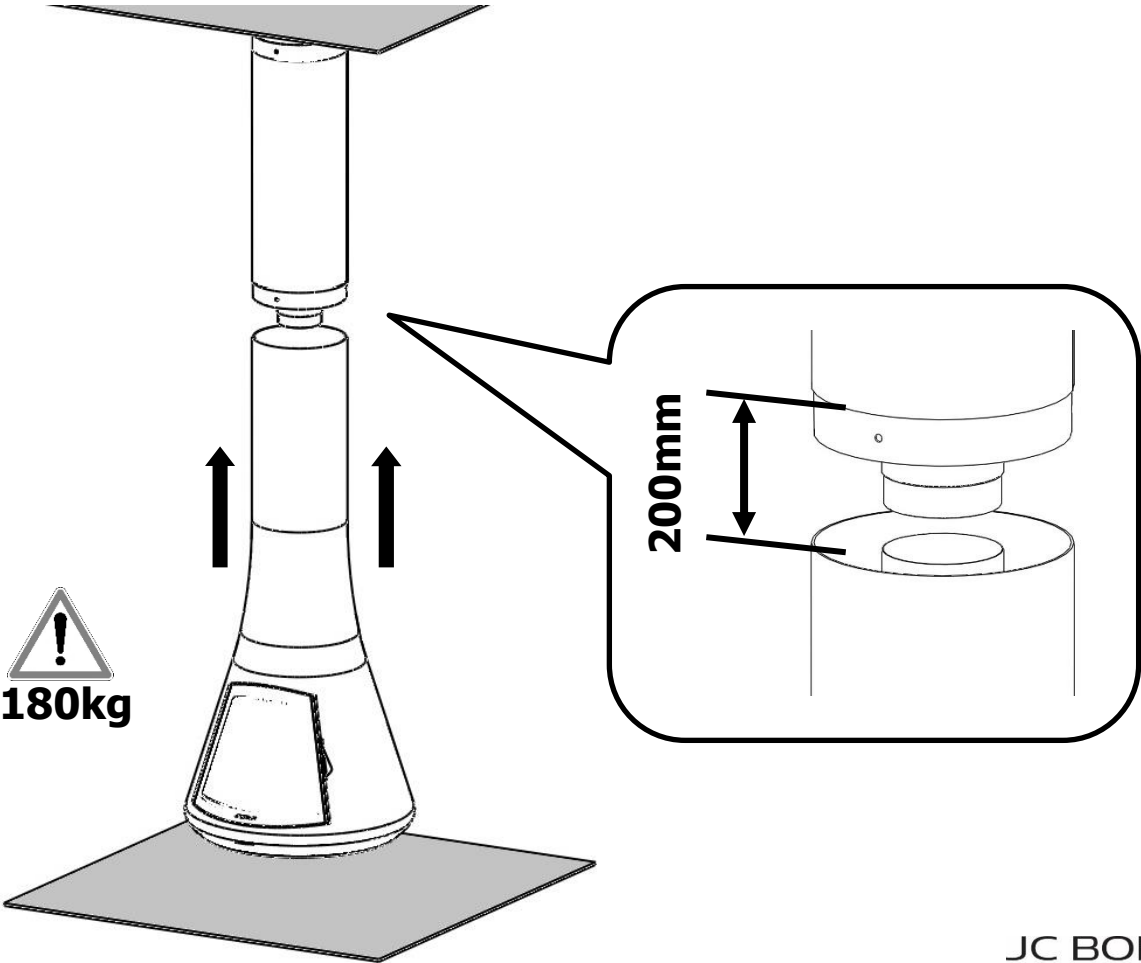

7.4

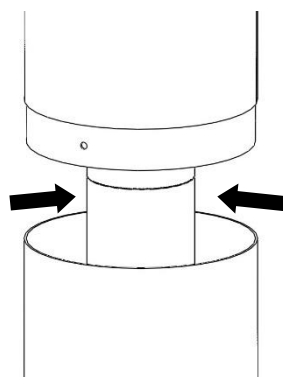
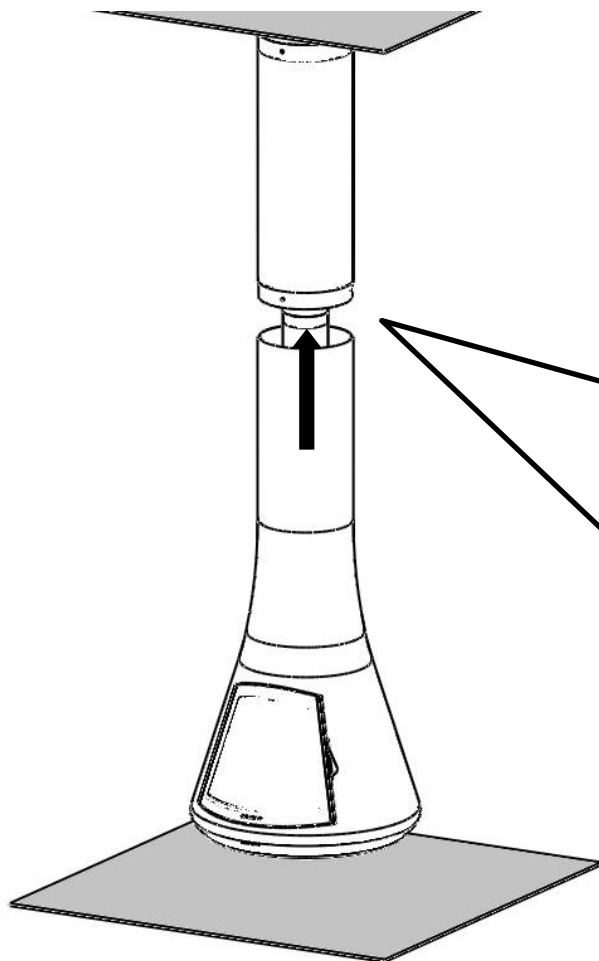

Fixing the lower element on the upper element:

- 3 steel or stainless steel rivets
- Mounting clamp

Duct connection

7.5

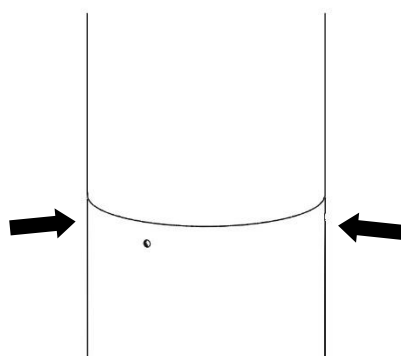
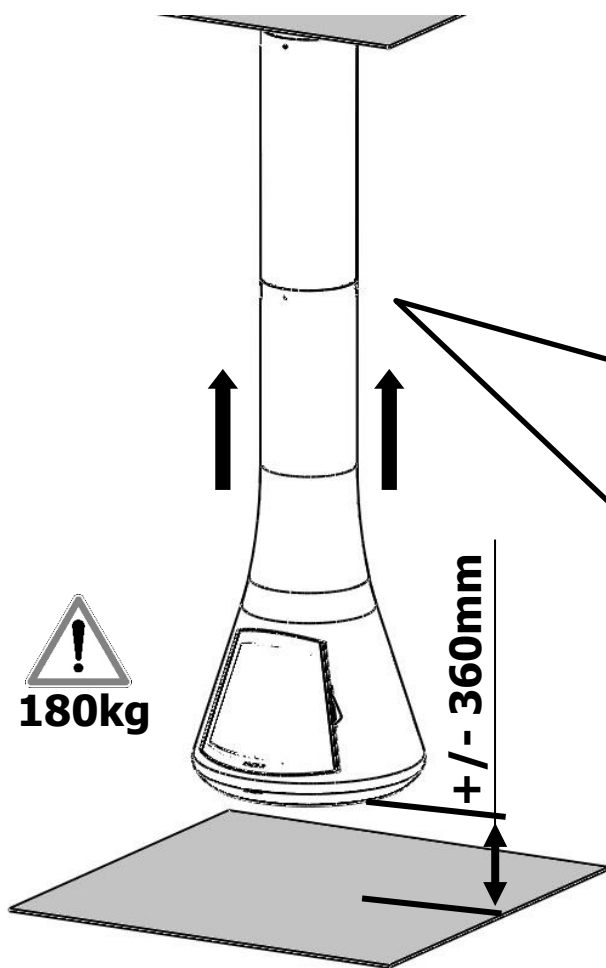

Fixing the Calista on the extension
- 3 countersunk head screws M8x20

8-ADJUSTMENT OF WALL SUPPORTS (WALL-MOUNTED)

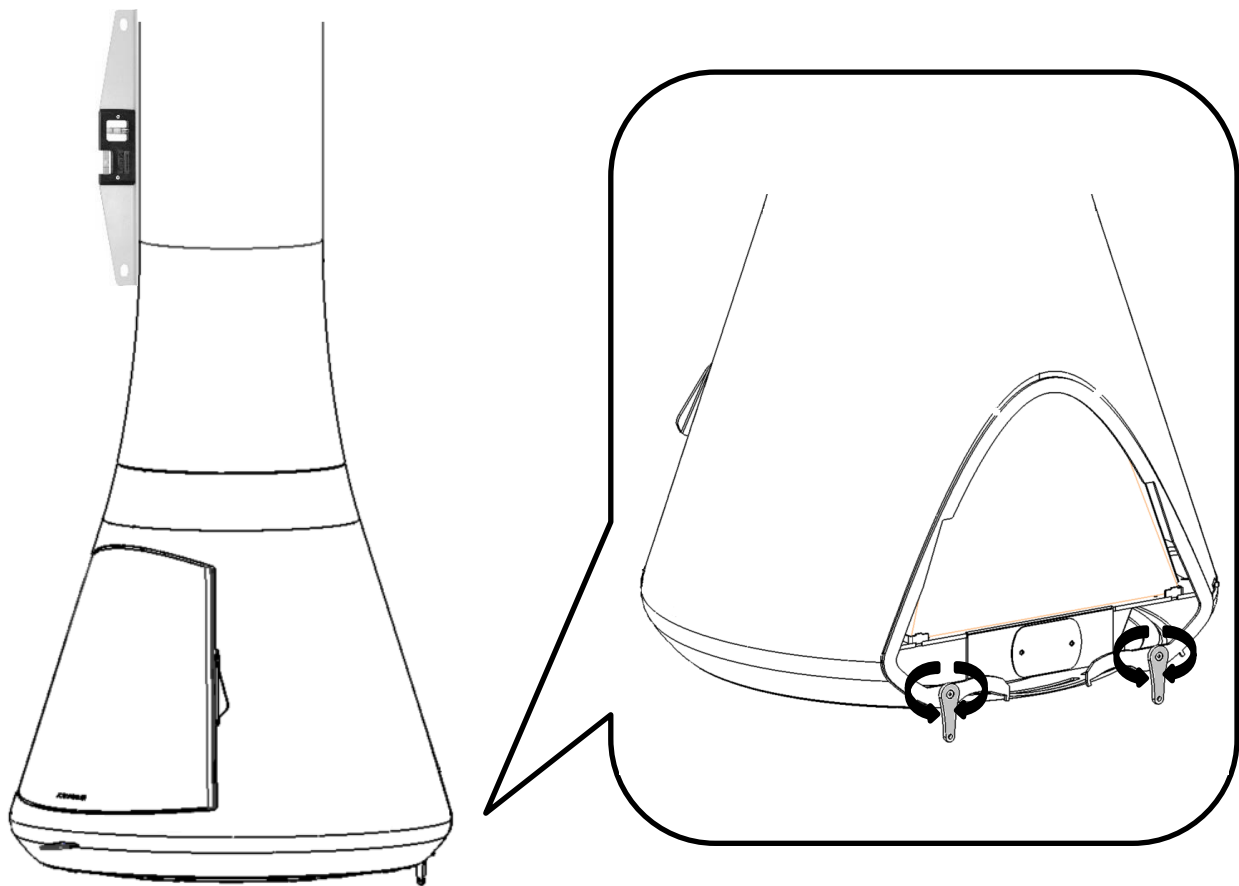

9-ANTI-SWAY SYSTEM (WALL-MOUNTED)

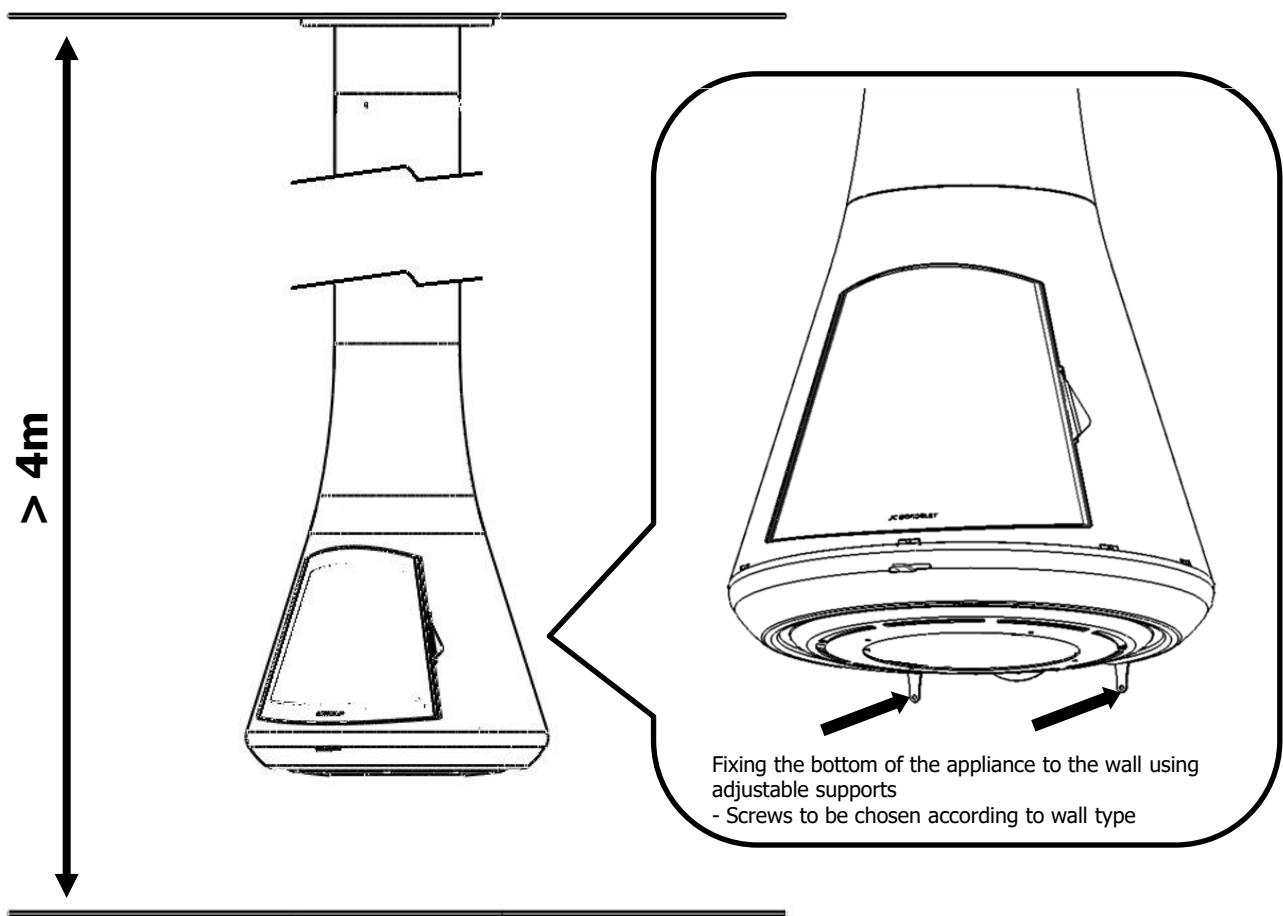

10-ADJUSTMENT OF THE TOP GLASS SCREEN CLEANING

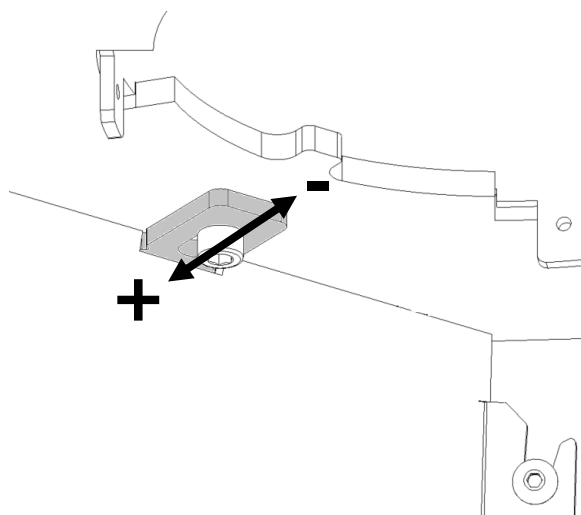
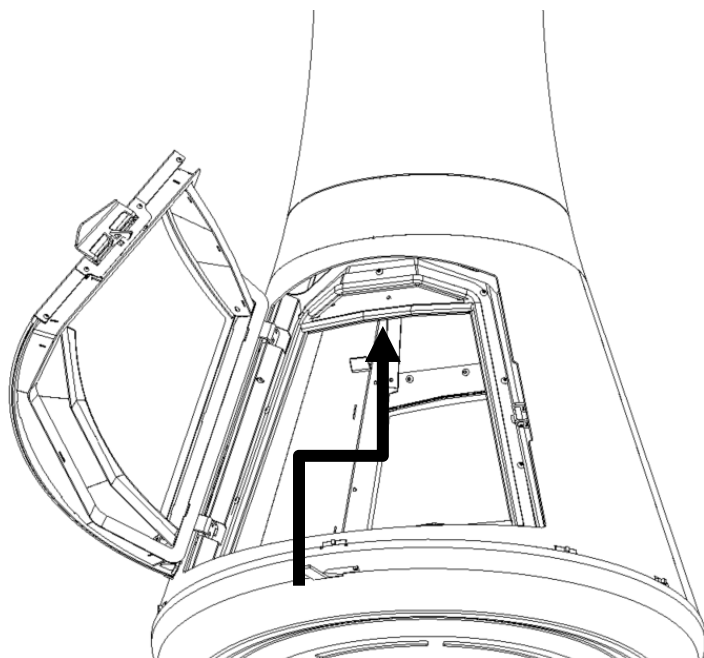

The top glass screen cleaning register(s) is accessible from inside the fireplace.

Loosen the screw to make the adjustment, then tighten the screw again

The glass screen cleaning is reduced when the register moves closer to the nozzle

The glass screen cleaning is increased when the register moves closer to the door.

11-ADJUSTMENT OF THE BOTTOM GLASS SCREEN CLEANING

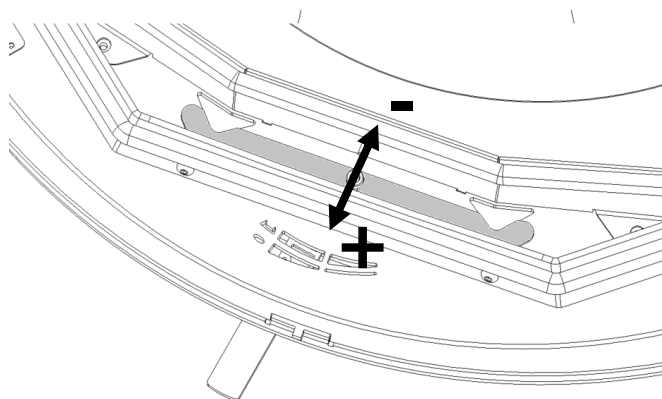
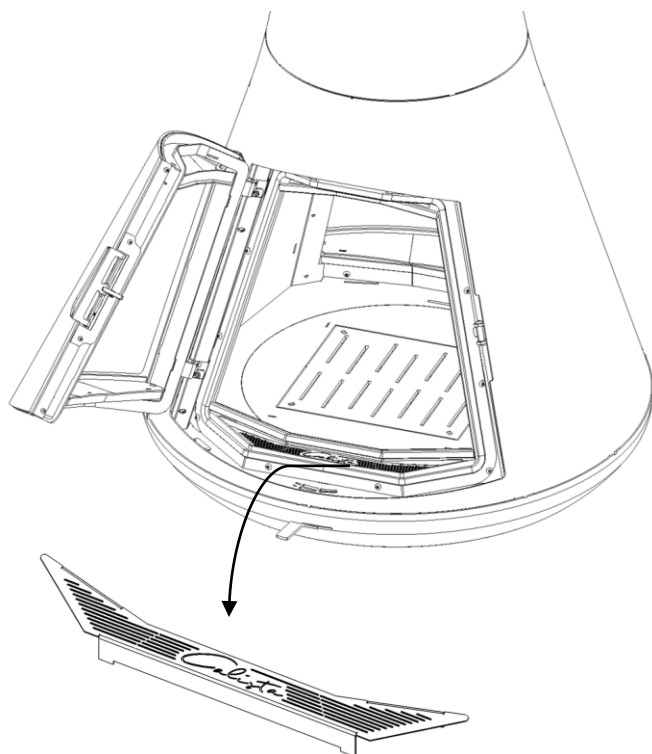

The bottom glass screen cleaning register(s) is accessible by removing «Calista» finishing grid.

Loosen the screw to make the adjustment, then tighten the screw again

The glass screen cleaning is reduced when the register moves closer to the centre of the fireplace

The glass screen cleaning is increased when the register moves closer to the door

Put the «Calista» finishing grid back after making the adjustment.

12-INSTALLATION OF DEFLECTORS

12.1

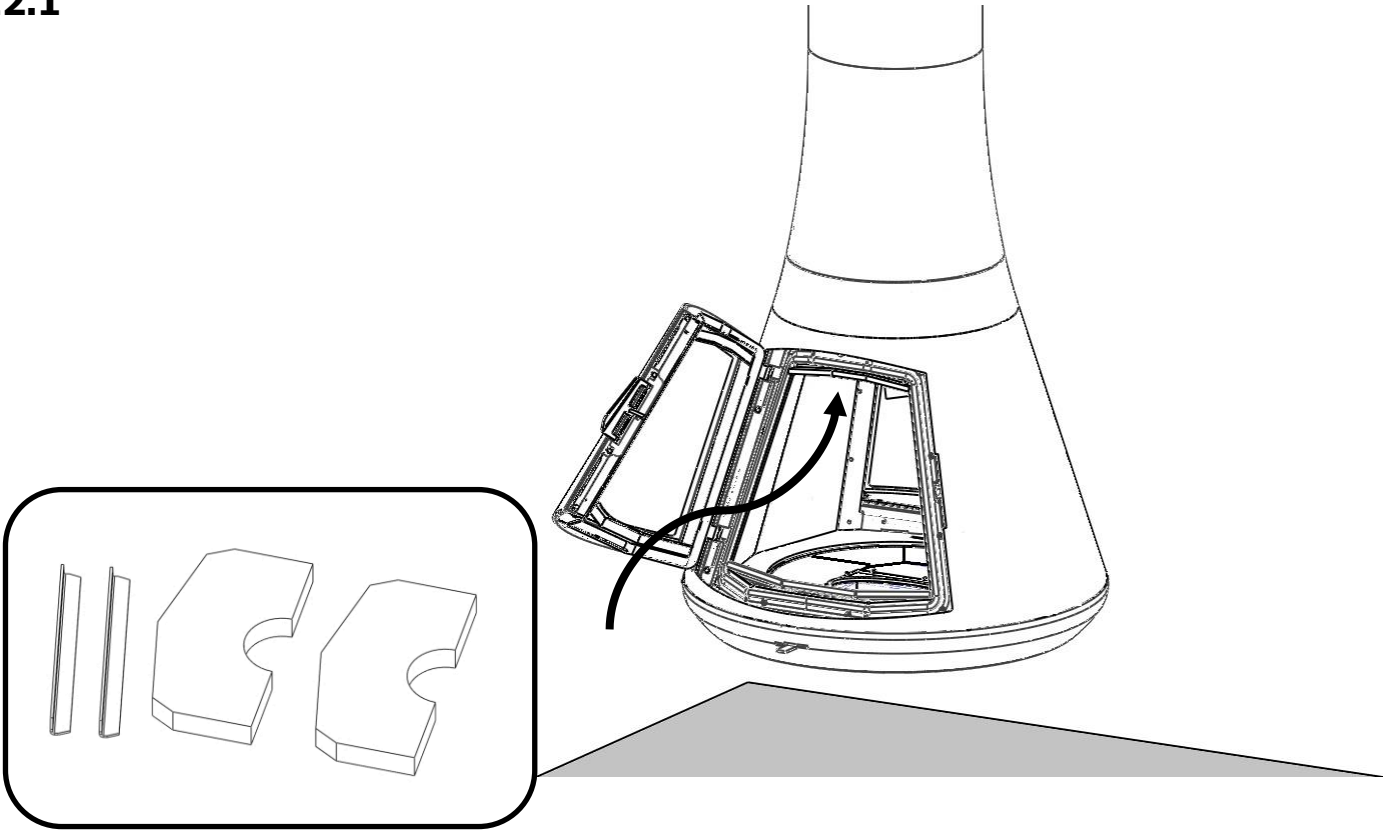

12.2

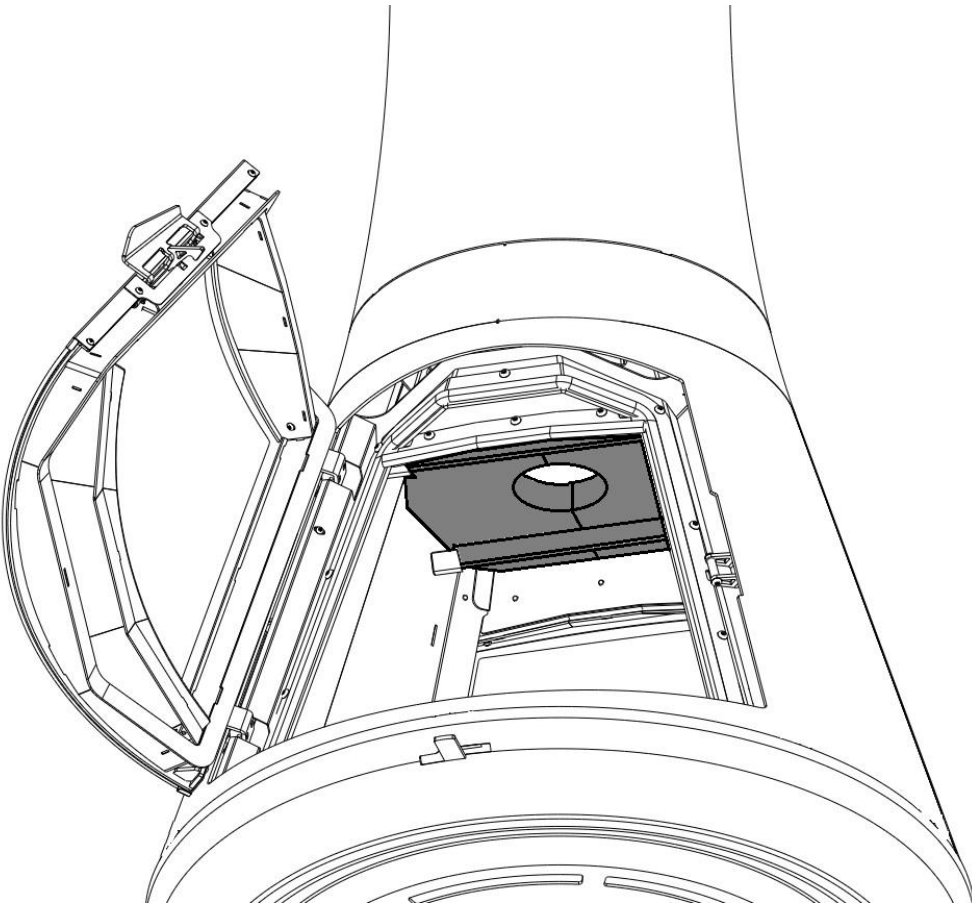

ORDERS	POSSIBLE REMEDIES
Soiling of the glass Backflow when opening the door Condensation Corrosion	<ul style="list-style-type: none"> - Burn wood with humidity <20% - Increase the combustion air supply * - Check the air supply settings of the device - Clean the device - Check the frequency of chimney sweeping (twice a year, including once during the period of use) - Clear the flue outlet of any disturbing element (eg satellite dish, etc.) * - Raise the cap on the smoke outlet * - Raise the flue (40 cm protrusion from the ridge) * - Insulate the flue *
Wood is hard to burn	<ul style="list-style-type: none"> - Use wood with a smaller section or in quarters - Put at least two logs (with the exception of densified logs) - Burn wood with humidity <20% - Increase the combustion air supply * - Clear the flue outlet of any disturbing element (eg satellite dish, etc.) * - Raise the cap on the smoke outlet * - Raise the flue (40 cm protrusion from the ridge) * - Insulate the flue *
The wood burns too fast	<ul style="list-style-type: none"> - Put logs of larger section - Check the presence of the deflectors in the device * - Check the adjustment of the air supply to the device * - Install a draft moderator *
Bistrage of the flue	<ul style="list-style-type: none"> - Burn wood with humidity <20% - Increase the combustion air supply - Clear the flue outlet of any disturbing element (eg satellite dish, etc.) * - Raise the cap on the smoke outlet * - Raise the flue (40 cm protrusion from the ridge) * - Insulate the flue *

* This operation must be carried out by a qualified professional.

JC BORDELET

c r é a t e u r d ' h a r m o n i e

ZI de Lhérat

63310 RANDAN

Tél: 0470561600 – Fax : 0470561689

www.bordelet.com

